

# defunc | TRUE MUTE

## QUICK GUIDE

### POWER ON AND OFF

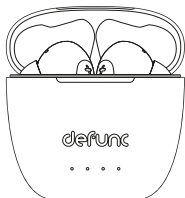

Power on: Open charging case  
Power off: Close charging case

Touch controls

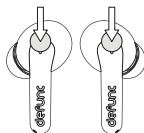

Power on: Press each earbud (3 sec)  
Power off: Press either earbud (5 sec)

### PAIR THE EARBUDS

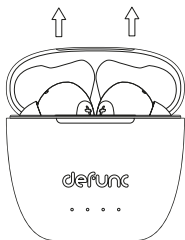

1. Open the charging case to auto-pair the earbuds.

### PAIR THE DEVICE

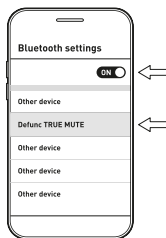

2. Turn on Bluetooth on your device.  
Select **Defunc TRUE MUTE** in the list.

# defunc | TRUE MUTE

## QUICK GUIDE

### TOUCH CONTROL COMMANDS

Tap or press the touch area to control different functions



#### Left earbud commands

- Volume decrease: 1 tap
- Previous track: 3 taps
- Voice assistant: 3 sec press
- Power on: 3 sec press
- Power off: 5 sec press
- Play/pause: 2 taps
- Answer/end call: 2 taps
- Reject call: 2 sec press

#### Right earbud commands

- Switch sound modes: 3 sec press
  - Mode 1 (default): Normal
  - Mode 2: Active noise cancellation
  - Mode 3: Transparency
- Volume increase: 1 tap
- Next track: 3 taps
- Power on: 3 sec press
- Power off: 5 sec press
- Play/pause: 2 taps
- Answer/end call: 2 taps
- Reject call: 2 sec press



### CHARGE THE EARBUDS AND CASE

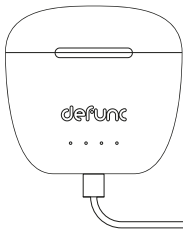

**Earbuds:** Put the earbuds in the case and close the cap. Case must have battery life.

**Charging case:** Plug one end of the cable into the case and the other end into a power source.

Case and earbuds can be charged simultaneously.