



KitchenAid

Hand Mixer
5KHM5110



EN	Use and Care Manual	2	NO	Håndbok for bruk og vedlikehold	117
DE	Gebrauchs- und Pflegeanleitung	15	FI	Käyttö- ja huolto-opas	129
FR	Manuel d'utilisation et d'entretien	29	DA	Vejledning til anvendelse og vedligehold	141
IT	Manuale d'uso e manutenzione	45	IS	Notenda & Meðhöndlunar handbók	153
NL	Gebruiks- en onderhoudshandleiding	57	RU	Руководство по эксплуатации и уходу	165
ES	Manual de uso y cuidado	69	PL	Instrukcja obsługi i konserwacji	177
PT	Manual de utilização e manutenção	81	CS	Návod k použití a údržbě	189
EL	Εγχειρίδιο Χρήσης και Φροντίδας	93	TR	Kullanım ve Bakım kılavuzu	201
SV	Handbok för skötsel och användning	105	AR	دليل الاستخدام والعناية	1





PARTS AND FEATURES

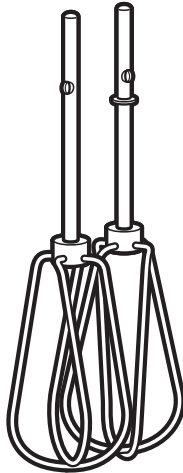
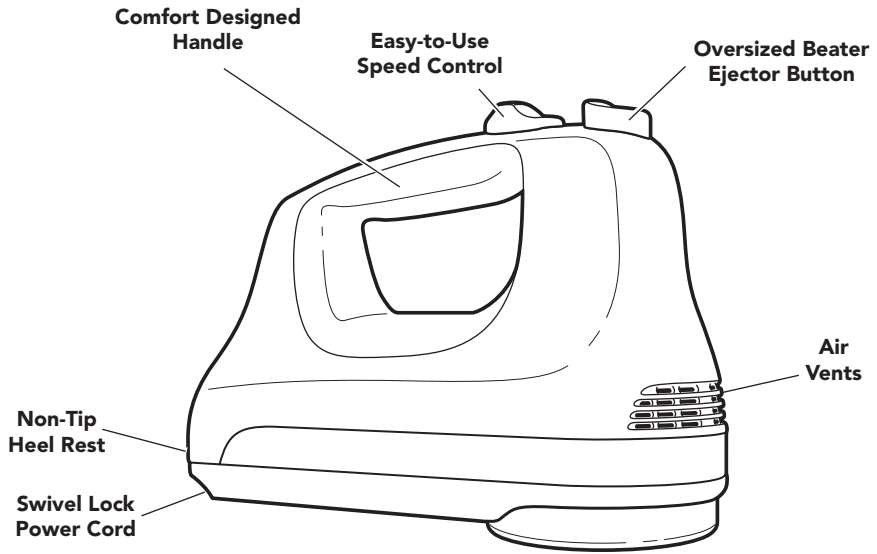

Stainless Steel Beater



16-Wire Whisk





PRODUCT SAFETY

Your safety and the safety of others are very important.

We have provided many important safety messages in this manual and on your appliance. Always read and obey all safety messages.



This is the safety alert symbol.

This symbol alerts you to potential hazards that can kill or hurt you and others.

All safety messages will follow the safety alert symbol and either the word "DANGER" or "WARNING." These words mean:

! DANGER

You can be killed or seriously injured if you don't immediately follow instructions.

! WARNING

You can be killed or seriously injured if you don't follow instructions.

All safety messages will tell you what the potential hazard is, tell you how to reduce the chance of injury, and tell you what can happen if the instructions are not followed.

IMPORTANT SAFEGUARDS

When using electrical appliances, basic safety precautions should always be followed, including the following:

1. Read all instructions. Misuse of appliance may result in personal injury.
2. To protect against risk of electrical shock, do not put the Hand Mixer in water or other liquid.
3. This appliance is not intended for use by persons (including children) with reduced physical, sensory, or mental capabilities, or lack of experience and knowledge, unless they have been given supervision or instructions concerning use of the appliance by a person responsible for their safety.
4. European Union Only: Appliances can be used by persons with reduced physical, sensory or mental capabilities or lack of experience and knowledge if they have been given supervision or instruction concerning use of the appliance in a safe way and understand the hazards involved. Children shall not play with the appliance.
5. European Union Only: This appliance shall not be used by children. Keep the appliance and its cord out of reach of children.
6. Children should be supervised to ensure that they do not play with the appliance.
7. If the supply cord is damaged, it must be replaced by the manufacturer, its service agent, or similarly qualified persons in order to avoid a hazard.
8. Turn the appliance OFF, then unplug from the outlet when not in use, before assembling or disassembling parts and before cleaning. To unplug, grasp the plug and pull from the outlet. Never pull from the power cord.
9. Avoid contacting moving parts. Keep hands, hair, and clothing, as well as spatulas and other utensils away from accessories during operation to reduce the risk of injury to persons and/or damage to the appliance.



PRODUCT SAFETY

10. Do not operate any appliance with a damaged cord or plug, or after the appliance malfunctions, or is dropped or damaged in any manner. Return appliance to the nearest Authorised Service Facility for examination, repair, or electrical or mechanical adjustment.
11. The use of attachments not recommended or sold by KitchenAid may cause fire, electric shock, or injury.
12. Never leave the appliance unattended while it is in operation.
13. Do not use the Hand Mixer outdoors.
14. Do not let cord hang over the edge of table or counter.
15. Do not let cord contact hot surface, including the stove.
16. Remove any accessories from Hand Mixer before washing.
17. Refer to the “Care and Cleaning” section for instructions on cleaning the surfaces in contact with food.
18. This appliance is intended to be used in household and similar applications such as:
 - staff kitchen areas in shops, offices and other working environments;
 - farm houses;
 - by clients in hotels, motels and other residential type environments;
 - bed and breakfast type environments.

SAVE THESE INSTRUCTIONS

Instructions are also available online, visit our website at:

www.KitchenAid.co.uk or www.KitchenAid.eu



PRODUCT SAFETY

ELECTRICAL REQUIREMENTS

Voltage: 220-240 VAC only.

Frequency: 50-60 Hz

ELECTRICAL EQUIPMENT WASTE DISPOSAL

Disposal of packing material

The packing material is recyclable and is marked with the recycle symbol . The various parts of the packing must therefore be disposed of responsibly and in full compliance with local authority regulations governing waste disposal.

Scrapping the product

This appliance is marked in compliance with European Directive 2012/19/EU, Waste Electrical and Electronic Equipment (WEEE).

- By ensuring this product is disposed of correctly, you will help prevent potential negative consequences for the environment and human health, which could otherwise be caused by inappropriate waste handling of this product.

The symbol  on the product or on the accompanying documentation indicates that it should not be treated as domestic waste but must be taken to an appropriate collection center for the recycling of electrical and electronic equipment.

For more detailed information about treatment, recovery and recycling of this product, please contact your local city office, your household waste disposal service or the shop where you purchased the product.

DECLARATION OF CONFORMITY

This appliance has been designed, constructed and distributed in compliance with the safety requirements of EC Directives: 2014/35/EU, 2014/30/EU, 2009/125/EC and 2011/65/EU (RoHS Directive).



PRODUCT USAGE

SPEED CONTROL GUIDE



5
4
3
2
1
OFF/0



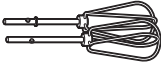
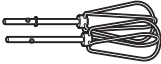
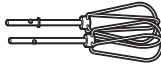
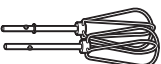

The 5-Speed Hand Mixer should always be set on the lowest speed to start mixing. Move to higher speeds as needed.

Speed	Attachment	Description
1		For slow stirring, combining, and starting all mixing procedures. Use this speed to stir in nuts, chocolate chips, shredded cheese, onions, olives, and other chunky ingredients. Mix flour and other dry ingredients with liquids or other moist mixtures. Helps avoid ingredient splash out.
2		Stir batters and gelatin mixtures. Combine heavy mixtures, such as cookie dough. Mix light cream cheese spreads. Mash potatoes.
3		Combine heavy cream cheese mixtures. Mash squash.
4/5		Blend butter and sugar. Mix muffins, quick breads, cake batters, and frostings.

NOTE: The Stainless Steel Beater accessories are not designed for mixing and kneading bread dough.

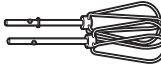
ACCESSORY GUIDE

Accessory	Uses	Included with Model
		5KHM5110
Stainless Steel Beater 	Cookie dough, cake batter	●
16-Wire Whisk 	Whip heavy cream and mousse mixtures	●
	Beat egg whites and meringue mixtures	●





PRODUCT USAGE

OPERATING THE SPEED CONTROL

This KitchenAid Hand Mixer will beat faster and more thoroughly than most other electric hand mixers. Therefore, the beating time in most recipes must be adjusted to avoid over beating. Beating time is faster due to larger beater sizes. To help determine the ideal beating time, observe the batter or dough and beat only until it has the desired appearance described in your recipe, such as "smooth and creamy". To select the best beating speeds, use the "Speed Control Guide" section.

⚠ WARNING

Injury Hazard

Unplug mixer before touching beaters.

Failure to do so can result in broken bones, cuts, or bruises.

1 Make sure the Speed Control is in the "OFF/0" position by sliding it backward as far as possible. "OFF/0" will be visible on the Speed Control pad. Then plug the Hand Mixer into an electrical outlet.

2 Start mixing at the lowest speed by sliding the Speed Control forward to the first position mark, which is Speed 1.

3 To increase the Hand Mixer speed, slide the Speed Control forward. To decrease the Hand Mixer speed, slide the Speed Control backward. See "Speed Control Guide" section.





PRODUCT USAGE

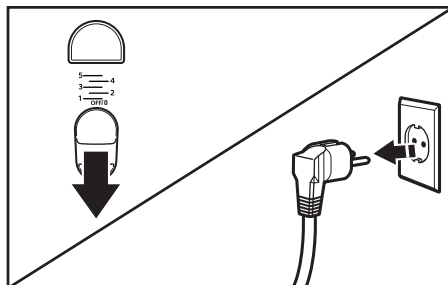

- 4 When finished, slide Speed Control to "OFF/0". Unplug the Hand Mixer before removing the accessories.

ATTACHING THE ACCESSORIES

Wash all accessories in warm, soapy water before use. Be sure the Hand Mixer is unplugged before cleaning, and putting on or taking off parts.

! WARNING

Injury Hazard

Unplug mixer before touching beaters.

Failure to do so can result in broken bones, cuts, or bruises.

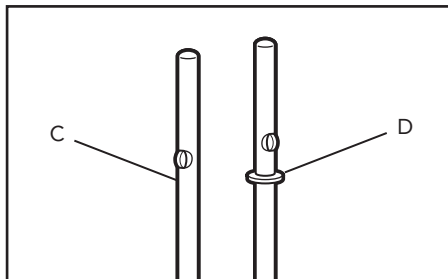

Paired accessories (Beaters, optional Dough Hooks) include one accessory with a collar (D), and one without (C). Single accessories, like the Pro Whisk, come without a collar (C).

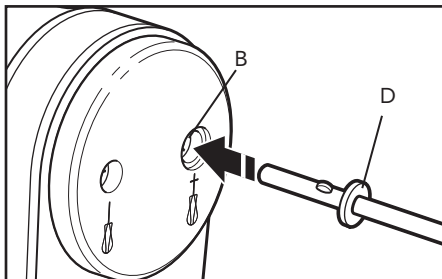

- 1 Insert the accessory shaft with the collar (D) into the larger opening (B) of the Hand Mixer. Align the flanges on the shaft with the slots in the opening. Push to lock into place.





PRODUCT USAGE

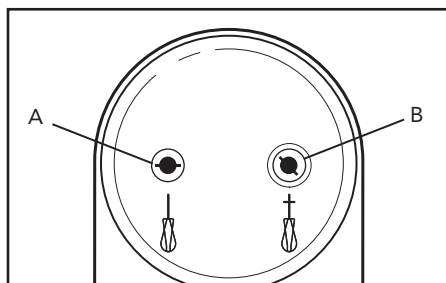

- 2 Insert the accessory without a collar (C) into the smaller opening (A). Align and push to lock into place.

NOTE: An accessory shaft without a collar may be used in either opening (A or B). Those with a collar may only be used in the larger opening (B).

REMOVING THE ACCESSORIES

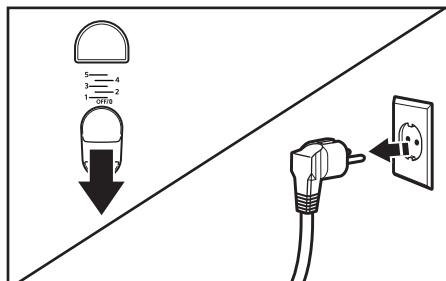

- 1 If the Hand Mixer is running, stop the Hand Mixer by sliding the Power switch to "OFF/0". Then unplug from the electrical outlet.

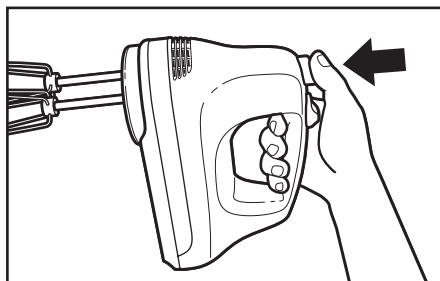

- 2 Press the Ejector Button to release the accessories from the Hand Mixer, then remove them.





CARE AND CLEANING

CLEANING THE HAND MIXER BODY

⚠ WARNING



Electrical Shock Hazard
Do not put in water.
Doing so can result in death or electrical shock.

⚠ WARNING

Injury Hazard
Unplug mixer before touching beaters.
Failure to do so can result in broken bones, cuts, or bruises.

NOTE: Do not immerse Hand Mixer in water.



1 Always unplug Hand Mixer before cleaning. Wipe Power Cord and cord strap with damp cloth. Dry with a soft cloth.



2 Wipe Hand Mixer with a damp cloth. Dry with a soft cloth.

CLEANING THE ACCESSORIES

To clean Stainless Steel Beaters and Pro Whisk: Always remove Beaters and Whisk from Hand Mixer before cleaning. Wash in top rack of dishwasher, or by hand in warm, soapy water. Rinse and wipe dry.

TROUBLESHOOTING

IF HAND MIXER MALFUNCTIONS OR FAILS TO OPERATE

First try the solutions suggested here and possibly avoid the cost of service.

1. Is the Hand Mixer plugged in?
2. Is the fuse in the circuit to the Hand Mixer in working order? If you have a circuit breaker box, make sure the circuit is closed.
3. Try unplugging the Hand Mixer, then plug it back in.

If the problem cannot be fixed with the steps provided in this section, then contact KitchenAid or an Authorized Service Center.

See the "Terms of KitchenAid Guarantee ("Guarantee")" section for additional details. Do not return the Hand Mixer to the retailers – they do not provide service.





TERMS OF KITCHENAID GUARANTEE ("GUARANTEE")

Covering U.K. - Ireland - South Africa - UAE

KitchenAid Europa, Inc., Nijverheidslaan 3, Box 5, 1853 Strombeek-Bever, Belgium ("Guarantor") grants the end-customer, who is a consumer, a Guarantee pursuant to the following terms.

FOR U.K.:

The Guarantee applies in addition to and does not limit or affect the statutory warranty rights of the end-customer against the seller of the product. In summary, the Consumer Rights Act 2015 says products must be as described, fit for purpose and of satisfactory quality. During the expected lifespan of your product your legal rights entitle you to the following:

- Up to 30 days: if your product is faulty, then you can get an immediate refund.
- Up to six months: if your product can't be repaired or replaced, then you're entitled to a full refund, in most cases.
- Up to six years: if your product does not last a reasonable length of time you may be entitled to some money back.

These rights are subject to certain exceptions. For detailed information please visit the Citizens Advice website www.adviceguide.org.uk or call **03454 04 05 06**.

FOR IRELAND:

The Guarantee applies in addition to and does not limit or affect the statutory warranty rights of the end-customer against the seller of the product under the European Communities (Certain Aspects of the Sale of Consumer Goods and Associated Guarantees Regulations 2003 (S.I. No. 11/2003)) and other enactments governing the sale of consumer goods.

FOR SOUTH AFRICA:

The Guarantee applies in addition to and does not limit or affect the statutory warranty rights of the end-customer against the seller of the product. In summary, the Consumer Protection Act, 2008 says that products must be: (i) reasonably suitable for the purpose for which they are intended; (ii) in good working order, of good quality and free of any defects; (iii) useable and durable for a reasonable period of time, having regard to the use to which they would normally be put and to all the surrounding circumstances; and (iv) in compliance with any applicable standards or any other public regulations.

During the expected lifespan of your product and where the products are not purchased online, your legal rights will entitle you to the following:

- You will be entitled to a full refund, if you did not have the opportunity to examine the product before delivery and if you rejected delivery of the product on the basis that the type and quality of the product was not as reasonably expected or did not reasonably conform to the material specifications.
- Within 5 business days after delivery: you may rescind your purchase and request a refund, if your purchase resulted from direct marketing.
- Within 10 business days after delivery: you will be entitled to a full refund, if it is found that the product was unsuitable for a particular purpose specifically communicated to you by the Guarantor.
- Within 15 business days after delivery: you will be entitled to a refund if: (i) the product was not delivered to you; or (ii) if you returned the product to the Guarantor.
- Within 6 months after delivery: you will be entitled to a refund or a replacement product, if the product is defective or fails to operate in terms of its specifications.





TERMS OF KITCHENAID GUARANTEE ("GUARANTEE")

Where you have purchased a product online your legal rights will be governed by the Electronic Communications and Transactions Act, 2002 and you will be entitled to the following:

- Within 7 days after conclusion of the transaction or after delivery: you may cancel your purchase without reason and without penalty.
- Within 30 days of the date of cancellation of the transaction: you will be entitled to receive a refund, if you have already made payment.
- You will only be liable for the direct costs of returning the product to the Guarantor.

FOR UAE:

The Guarantee applies in addition to and does not limit or affect the statutory warranty rights of the end-customer against the seller of the product.

1) SCOPE AND TERMS OF THE GUARANTEE

a) The Guarantor grants the Guarantee for the products mentioned under Section 1.b) which a consumer has purchased from a seller or a company of the KitchenAid-Group within the following countries: U.K., Ireland, or South Africa, or the United Arab Emirates (UAE).

b) The Guarantee period depends on the purchased product and is as follows:

5KHM5110 Two years full guarantee from date of purchase.

c) The Guarantee period commences on the date of purchase, i.e. the date on which a consumer purchased the product from a dealer or a company of the KitchenAid-Group.

d) The Guarantee covers the defect-free nature of the product.

e) The Guarantor shall provide the consumer with the following services under this Guarantee, at the choice of the Guarantor, if a defect occurs during the Guarantee period:

- Repair of the defective product or product part, or
- Replacement of the defective product or product part. If a product is no longer available, the Guarantor is entitled to exchange the product for a product of equal or higher value.

f) If the consumer wishes to make a claim under the Guarantee, the consumer has to contact the country specific KitchenAid service centres or the Guarantor directly at KitchenAid Europa, Inc. Nijverheidslaan 3, Box 5, 1853 Strombeek-Bever, Belgium;

Email-Address U.K.: CONSUMERCARE.UK@kitchenaid.eu

Email-Address IRELAND: CONSUMERCARE.IE@kitchenaid.eu

Toll Free Number U.K. & IRELAND: **00 800 381 040 26**

FOR SOUTH-AFRICA:

Our local KitchenAid Distributor:

KitchenAid Africa
PO Box 52102
V&A Waterfront
Cape Town
8002





TERMS OF KITCHENAID GUARANTEE ("GUARANTEE")

Contact our distributor:

Telephone: +27 21 555 0700

You can contact our Customer Service Centre for Small Domestic Appliances from 8.30 am to 1.00pm and from 1.30 pm to 5.00 pm or write to us at the following address: hello@kitchenaidafrica.com

FOR UAE:

AL GHANDI ELECTRONICS.

POST BOX NO. 9098,

DUBAI, UNITED ARAB EMIRATES

Toll free number: +971 4 2570007

g) The costs of repair, including spare parts, and the postage costs (if applicable) for the delivery of a defect-free product or product part shall be borne by the Guarantor. The Guarantor shall also bear the postage costs for returning the defective product or product part if the Guarantor or the country specific KitchenAid customer service centre requested the return of the defective product or product part. However, the consumer shall bear the costs of appropriate packaging for the return of the defective product or product part.

h) To be able to make a claim under the Guarantee, the consumer must present the receipt or invoice of the purchase of the product.

2) LIMITATIONS OF THE GUARANTEE

a) **The Guarantee applies only to products used for private purposes and not for professional or commercial purposes.**

b) **The Guarantee does not apply in the case of normal wear and tear, improper or abusive use, failure to follow the instructions for use, use of the product at the wrong electrical voltage, installation and operation in violation of the applicable electrical regulations, and use of force (e.g. blows).**

c) **The Guarantee does not apply if the product has been modified or converted, e.g. conversions from 120 V products to 220-240 V products.**

d) **The provision of Guarantee services does not extend the Guarantee period, nor does it initiate the commencement of a new Guarantee period. The Guarantee period for installed spare parts ends with the Guarantee period for the entire product.**

e) FOR SOUTH-AFRICA & UAE ONLY:

Further or other claims, in particular claims for damages, are excluded unless liability is mandatory by law.

After expiry of the Guarantee period or for products for which the Guarantee does not apply, the KitchenAid customer service centres are still available to the end-customer for questions and information.

Further information is also available on our website:

- For U.K. & Ireland www.kitchenaid.eu

- For South-Africa: www.kitchenaidafrica.com

- For UAE: www.KitchenAid-MEA.com

PRODUCT REGISTRATION

Register your new KitchenAid appliance now: <http://www.kitchenaid.eu/register>

