

Washing Machine User manual

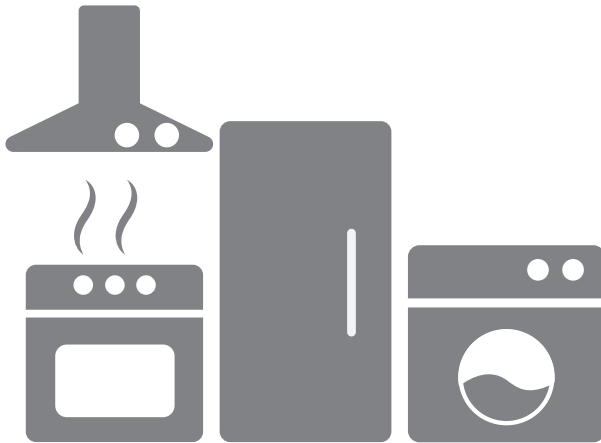





FT915GS3104A

Cylinda
en enklare vardag

Thank you for choosing this product.

This User Manual contains important safety information and instructions on the operation and maintenance of your appliance.

Please take the time to read this User Manual before using your appliance and keep this book for future reference.

Icon	Type	Meaning
	WARNING	Serious injury or death risk
	RISK OF ELECTRIC SHOCK	Dangerous voltage risk
	FIRE	Warning; Risk of fire / flammable materials
	CAUTION	Injury or property damage risk
	IMPORTANT / NOTE	Operating the system correctly

CONTENT

1. SAFETY INSTRUCTIONS	1
1.1 General Safety Warnings	2
1.2 During Use	7
1.3 Packaging and Environment	8
1.4 Savings Information	9
2. TECHNICAL SPECIFICATIONS	10
2.1 Overview	10
2.2 Technical Specifications	10
3. INSTALLATION	11
3.1 Removing the Transit Bolts	11
3.2 Adjusting the Feet / Adjusting Adjustable Stays	11
3.3 Electrical Connection	12
3.4 Water Inlet Hose Connection	12
3.5 Water Discharge Connection	13
4. INTRODUCTION OF CONTROL PANEL	13
4.1 Detergent Drawer	14
4.2 Sections	14
4.3 Electronic Display	15
4.4 Major symbol descriptions	16
5. USING YOUR WASHING MACHINE	17
5.1 Preparing Your Laundry	17
5.2 Putting Laundry in the Machine	17
5.3 Adding Detergent to the Machine	18
5.4 Operating Your Machine	18
5.5 Selecting a Programme	19
5.6 Half-Load Detection System	19
5.7 Auxiliary Functions	19
5.8 Child Lock	22
5.9 If you want to cancel a running program:	23
5.10 Program End	23
6. PROGRAM TABLE	24
6.1 Important Information	27
7. CLEANING AND MAINTENANCE	28
7.1 Warning	28
7.2 Water Inlet Filters	28
7.3 Pump Filter	29
7.4 Detergent Drawer	29
8. Body / Drum	30
9. TROUBLESHOOTING	31
10. AUTOMATIC FAULT WARNINGS AND WHAT TO DO	32

1. SAFETY INSTRUCTIONS

Operation voltage / frequency (V/Hz)	(220-240) V~/50Hz
Total current (A)	10
Water pressure (Mpa)	Maximum 1 Mpa / Minimum 0.1 Mpa
Total power (W)	2100
Total dry laundry capacity (kg)	10,5

- Do not install your machine on a carpet or such grounds that would prevent the ventilation of its base.
- The appliance is not intended for use by people (including children) with reduced physical, sensory or mental capabilities, or lack of experience and knowledge unless they have been given supervision or instruction concerning use of the appliance by a person responsible for their safety.
- Children of less than 3 years should be kept away unless continuously supervised.
- Call the nearest authorised service centre for a replacement if the power cord malfunctions.
- Use only the new water inlet hose that is provided with your machine when connecting to water supply. Never use old, used or damaged water inlet hoses.

- Children should not play with the appliance.
- Cleaning and user maintenance should not be made by children without supervision.

 **NOTE:** For a softcopy of this user manual, please contact the following address: “washingmachine@standardtest.info”. In your e-mail, please provide the model name and serial number (20 digits) which you can find on the appliance door.

Read this user manual carefully.

Your machine is for domestic use only. Using it for commercial purposes will cause your warranty to be cancelled.



This manual has been prepared for more than one model therefore your appliance may not have some of the features described within. For this reason, it is important to pay particular attention to any figures whilst reading the operating manual.

1.1 General Safety Warnings

- The necessary ambient temperature for operation of your Washing Machine is 15-25 °C.
- Where the temperature is below 0 °C, hoses may split or the electronic card may not operate correctly.
- Please ensure that garments loaded into your Washing Machine are free from foreign objects such as nails, needles, lighters and coins.

- **It is recommended that for your first wash, you select the 90° Cotton programme without laundry and half fill compartment II of the detergent drawer with a suitable detergent.**
- To avoid a buildup of detergent residue, only put softener or detergent in the drawer at the beginning of each wash.
- Unplug your Washing Machine and switch off the water supply if the Washing Machine is left unused for a long time. We also recommend that you leave the door open to prevent build up of humidity inside the Washing Machine.
- Some water may be left in your Washing Machine as a result of quality checks during production. This will not affect the operation of your Washing Machine.
- The packaging of the machine could be hazardous to children. Do not allow children to play with the packaging or small parts from the Washing Machine.
- Keep the packaging materials in a place where children cannot reach them, or dispose of them appropriately.
- Use pre-wash programs only for very dirty laundry.

 Never open the detergent drawer while the machine is running.

- In the event of a breakdown, unplug the machine from the mains supply and turn the water supply off. Do not attempt to carry out any repairs.

Always contact an authorised service agent.

- Do not exceed the maximum load for the washing programme you have chosen.

⚠ Never force the door open when your Washing Machine is running.

- Washing laundry containing flour may damage your machine.
- Please follow the manufacturers' instructions regarding the use of fabric conditioner or any similar products that you intend to use in your Washing Machine.
- Make sure that the door of your Washing Machine is not restricted and can be opened fully.

Install your machine in a location that can be fully ventilated and preferably has constant air circulation.

Door emergency opening function

The door will remain locked when the machine is running, when the programme is not yet complete or in the event of a power cut.

To open the door;

1. Please turn off the machine. Take off the power plug from the mains socket.
2. To drain the waste water, follow the instructions given in cleaning the pump filter section.
3. Pull down the emergency opening mechanism with the help of a tool and open the door at the same time.



4. If the door remains locked after being closed again, move the emergency opening handle to the open position.

⚠️ Read these warnings. Follow the advice given to protect yourself and others from risks and fatal injuries.

RISK OF BURNS

⚠️ Do not touch the drain hose or any discharged water while your Washing Machine is running. The high temperatures involved pose a burn risk.

⚠️⚡ RISK OF DEATH FROM ELECTRICAL CURRENT

- Do not connect your Washing Machine to the mains electricity supply using an extension lead.
- Do not insert a damaged plug into a socket.
- Never remove the plug from the socket by pulling the cord. Always hold the plug.
- Never touch the power cord/plug with wet hands as this could cause a short circuit or electric shock.
- Do not touch your Washing Machine if your hands or feet are wet.
- A damaged power cord/plug can cause fire or give you an electric shock. When damaged it must be replaced, this should only be done by qualified personnel.

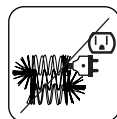
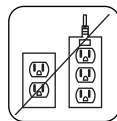

⚠️ Risk of flooding

- Check the speed of water flow before placing the drain hose in a sink.

- Take necessary measures to prevent the hose from slipping.
- Water flow may dislodge the hose if it is not properly secured. Make sure the plug in your sink does not block the plug hole.

Danger of Fire

- Do not store inflammable liquids near your machine.
- The sulphur content of paint removers may cause corrosion. Never use paint removing materials in your machine.
- Never use products that contain solvents in your machine.
- Please ensure that garments loaded into your Washing Machine are free from foreign objects such as nails, needles, lighters and coins.

Risk of fire and explosion

Risk of falling and injury

- Do not climb on your Washing Machine.
- Make sure hoses and cables do not cause a trip hazard.
- Do not turn your Washing Machine upside down or on its side.
- Do not lift your Washing Machine using the door or detergent drawer.

 **The machine must be carried by at least 2 people.**



Child safety

- Do not leave children unattended near the machine. Children might lock themselves in the machine resulting in risk of death.
- Do not allow children to touch the glass door during operation. The surface becomes extremely hot and may cause damage to skin.
- Keep packaging material away from children.
- Poisoning and irritation may occur if detergent and cleaning materials are consumed or come into contact with the skin and eyes. Keep cleaning materials out of the reach of children.



1.2 During Use

- Keep pets away from your machine.
- Please check the packaging of your machine before installation and the outer surface of the machine once the packaging has been removed. Do not operate the machine if it appears damaged or if the packaging has been opened.
- Your machine must only be installed by an authorised service agent. Installation by anyone other than an authorised agent may cause your warranty to be void.
- Children and persons with reduced physical, sensory or mental capabilities and lack of experience and knowledge should not use this appliance without supervision.
- Cleaning and user maintenance shall not be done

- by children without supervision.
- Only use your machine for laundry that is labelled as suitable for washing by the manufacturer.
 - **Before operating the washing machine, remove the 4 transit bolts and rubber spacers from the rear of the machine. If the bolts are not removed they may cause heavy vibration, noise and malfunction of the machine and cause the guarantee to be void.**
 - Your warranty does not cover damage caused by external factors such as fire, flooding and other sources of damage.
 - Please do not throw away this user manual; keep it for future reference and pass it onto the next owner.

 **NOTE:** Specifications for the machine may vary depending on the product purchased.

Replacement of drive belt, only by authorized service.

Only original spare belt must use.

1.3 Packaging and Environment

Removal of packaging materials

Packaging materials protect your machine from any damage that might occur during transportation. The packaging materials are environmentally friendly as they are recyclable. Use of recycled material reduces raw material consumption and decreases waste production.

1.4 Savings Information

Some important information to get the most efficient use out of your machine:

- Do not exceed the maximum load for the washing programme you have chosen. This will allow your machine to run in energy saving mode.
- Do not use the pre-wash feature for lightly soiled laundry. This will help you save on the amount of electricity and water consumed.

CE Declaration of conformity

We declare that our products meet the applicable European Directives, Decisions and Regulations and the requirements listed in the standards referenced.

Disposal of your old machine



The symbol on the product or on its packaging indicates that this product may not be treated as household waste. Instead it shall be handed over to the applicable collection point for the recycling of electrical and electronic equipment. By ensuring this product is disposed of correctly, you will help prevent potential negative consequences for the environment and human health, which could otherwise be caused by inappropriate waste handling of this product. For more detailed information about recycling of this product, please contact your local city office, your household waste disposal service or the shop where you purchased the product.

2. TECHNICAL SPECIFICATIONS

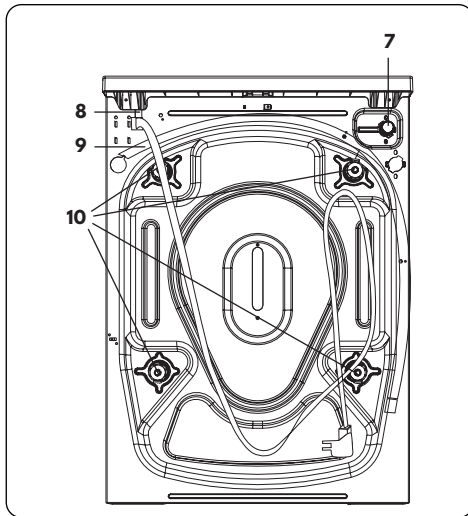
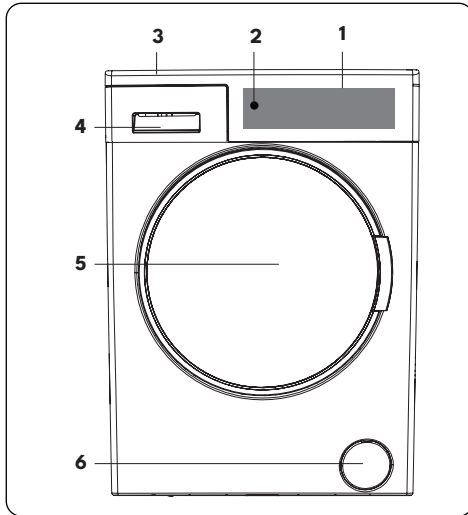

2.1 Overview

1. Electronic Display
2. On / Off Button
3. Upper Table
4. Detergent Drawer
5. Door
6. Pump Filter Cover
7. Water Inlet Valve
8. Power Cord
9. Discharge Hose

10. Transport Safety Screw

2.2 Technical Specifications

Operation voltage / frequency (V/Hz)	(220-240) V~/50Hz
Total current (A)	10
Water pressure (Mpa)	Maximum: 1 Mpa Minimum: 0.1 Mpa
Total power (W)	2100
Total dry laundry capacity (kg)	10,5
Spin speed (rpm)	1400
Number of programs	12
Dimensions (mm)	
Height	845
Width	597
Depth	557

3. INSTALLATION

3.1 Removing the Transit Bolts

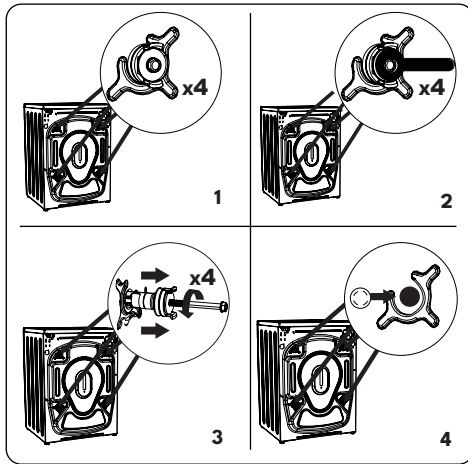

1. Before operating the washing machine, remove the 4 transit bolts and rubber spacers from the rear of the machine. If the bolts are not removed, they may cause heavy vibration, noise and malfunction of the machine and void the warranty.
2. Loosen the transit bolts by turning them anticlockwise with an appropriate spanner.
3. Remove the transit bolts with a straight pull.
4. Fit the plastic blanking caps supplied in the accessories bag into the gaps left by the removal of the transit bolts. The transit bolts should be stored for future use.

NOTE: Remove the transit bolts before using the machine for the first time. Faults occurring due to the machine being operated with transit bolts fitted are out of the scope of the warranty.

3.2 Adjusting the Feet / Adjusting Adjustable Stays

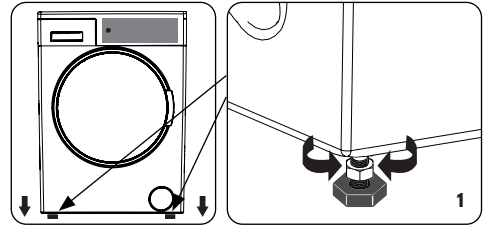

1. Do not install your machine on a surface (such as carpet) that would prevent ventilation at the base.
 - To ensure quiet and vibration-free operation of your machine, install it on a firm surface.
 - You can level your machine using the adjustable feet.
 - Loosen the locking nut.

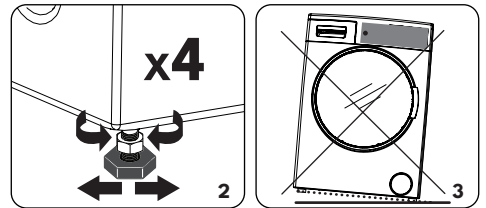

2. To increase the height of the machine, turn the feet clockwise. To decrease the height of the machine, turn the feet anticlockwise.
 - Once the machine is level, tighten the locking nuts by turning them clockwise.
3. Never insert cardboard, wood or other similar materials under the machine to level it.
 - When cleaning the ground on which the machine is located, take care not to disturb the level of the machine. ,

3.3 Electrical Connection

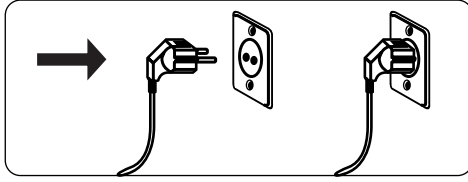

- Your Washing Machine requires a 220-240V, 50 mains supply.
- The mains cord of your washing machine is equipped with an earthed plug. This plug should always be inserted to an earthed socket of 10 amps.
- If you do not have a suitable socket and fuse conforming with this, please ensure the work is carried out by a qualified electrician.
- We do not take responsibility for damage that occurs due to the use of ungrounded equipment.

NOTE: Operating your machine with low voltage will cause the life cycle of your machine to be reduced and its performance to be restricted.

3.4 Water Inlet Hose Connection

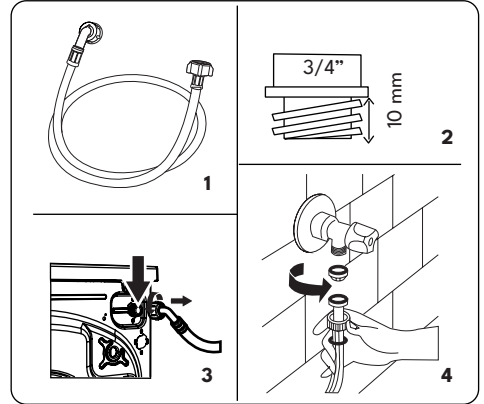

1. Your machine may have either a single water inlet connection (cold) or double water inlet connection (hot and cold) depending on the machine specifications. The white capped hose should be connected to cold water inlet and red capped hose to the hot water inlet (if applicable).
 - To prevent water leaks at the joints, either 1 or 2 nuts (depending on your machine's specifications) are supplied in the packaging with the hose. Fit these nuts to the end(s) of the water inlet hose that connect to the water supply.
2. Connect new water inlet hoses to a $\frac{3}{4}$ " threaded tap.
 - Connect the white capped end of the water inlet hose to the white water inlet valve on the rear side of the machine and the red capped end of

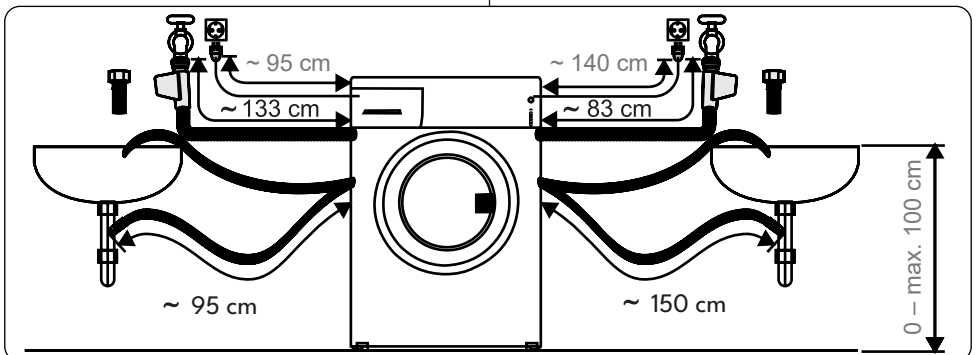

the hose to the red water inlet valve (if applicable).

- Tighten the plastic parts of the connections by hand. If in any doubt, consult a qualified plumber.
 - Water flow with pressure of 0.1-1 Mpa will allow your machine to operate at optimum efficiency (pressure of 0.1 Mpa means that more than 8 litres of water per minute will flow through a fully opened tap).
3. Once you have made all of the connections, carefully turn the water supply on and check for leaks.
 4. Ensure that the new water inlet hoses are not trapped, kinked, twisted, folded or crushed.
 - If your machine has a hot water inlet connection, the temperature of the hot water supply should not be higher than 70°C.

NOTE: Your Washing Machine must only be connected to your water supply using the supplied new fill hose. Old hoses must not be reused.

3.5 Water Discharge Connection

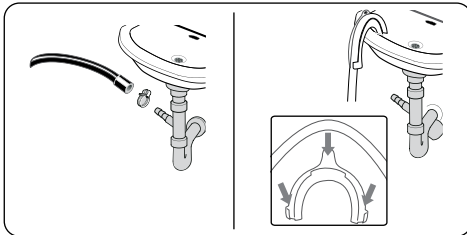

- Connect the water drain hose to a standpipe or to the outlet elbow of a household sink, using additional equipment.
- Never attempt to extend the water drain hose.
- Do not put the water drain hose from your machine into a container, bucket or bathtub.
- Make sure that the water drain hose is not bent, buckled, crushed or extended.

- The water drain hose must be installed at a maximum height of 100 cm from the ground.

4. INTRODUCTION OF CONTROL PANEL

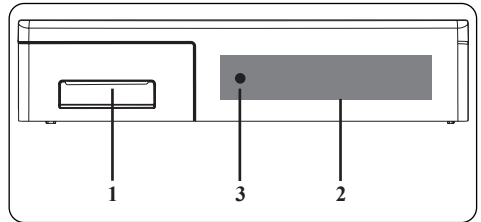

1. Detergent Drawer
2. Electronic Display
3. On / Off Button

4.1 Detergent Drawer

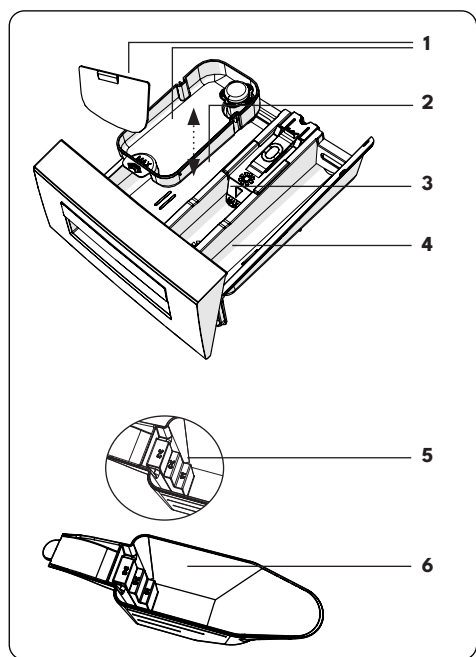
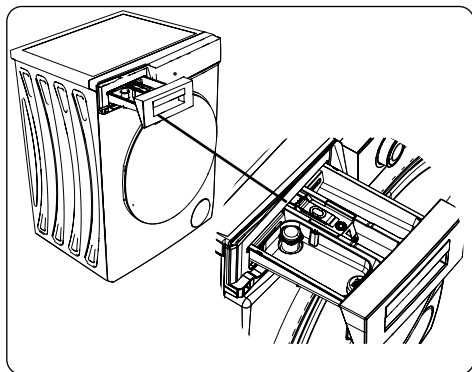

1. Liquid Detergent Attachments (*)
2. Main Wash Detergent Compartment
3. Softener Compartment
4. Pre-Wash Detergent Compartment
5. Powder Detergent Levels
6. Powder Detergent Scoop (*)

(*) Specifications may vary depending on the machine purchased.

4.2 Sections

Main wash detergent compartment:

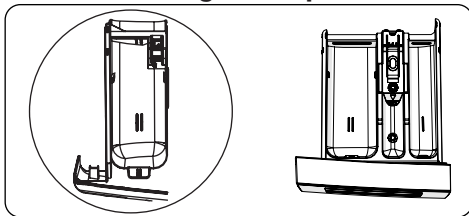

This compartment is for liquid or powder detergents or limescale remover. The fluid detergent level plate will be supplied inside your machine. (*)

Fabric conditioner, starch, detergent compartment:

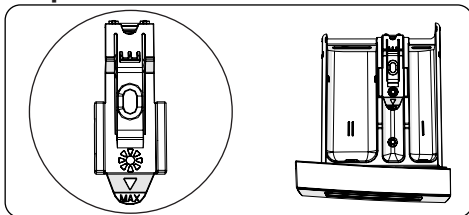

This compartment is for softeners, conditioners or starch. Follow the instructions on the packaging. If softeners leave residue after use, try diluting them or using a liquid softener.

Pre-wash detergent compartment:

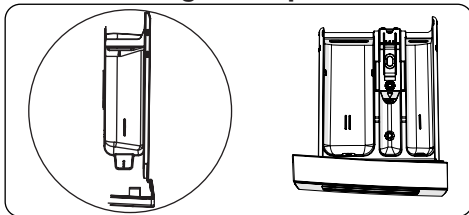

This compartment should be used only when the pre-wash feature is selected. We recommend that the pre-wash feature is used only for very dirty laundry.

(*) Specifications may vary depending on the machine purchased.

4.3 Electronic Display

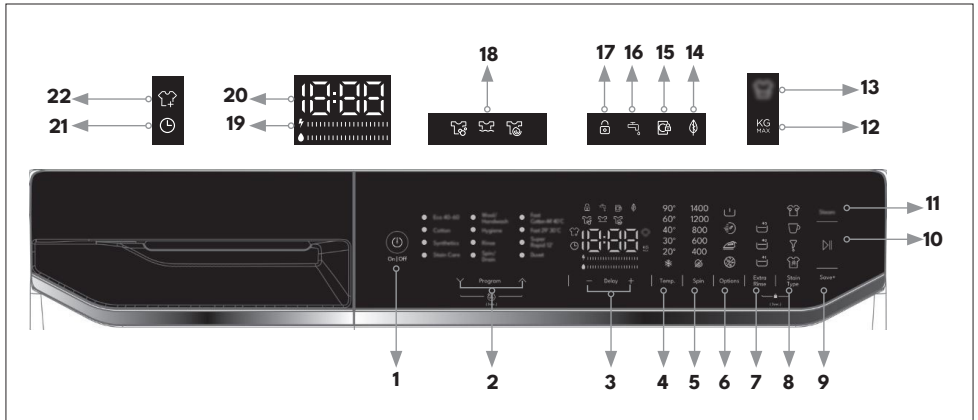

- | | |
|--|---|
| <ol style="list-style-type: none"> 1. On / Off Button 2. Touch Control Program Direction Keys 3. Delayed Start Auxiliary Function Keys 4. Wash Water Temperature Adjustment Key 5. Spin Speed Adjustment Key 6. Options Key 7. Extra Rinse Function Key 8. Stain Type Selection 9. Save+ Mode Auxiliary Function Key 10. Start/Pause Key 11. Auxiliary Function Key | <ol style="list-style-type: none"> 12. Program Max. Laundry Load LED Light 13. Active Auxiliary Function LED Light 14. Save+ Mode Active LED Light 15. Door Closed LED Light 16. Water Cut Off LED Light 17. Child Lock LED Light 18. Program Phase LED Light (Shows Washing, Rinsing and Spinning steps.) 19. Energy/Water Efficiency Bar 20. Digital Display 21. Delayed Start LED Light 22. Add Laundry LED Light |
|--|---|

4.4 Major symbol descriptions

2 When the On / Off button is pressed, your machine is turned on with the Eco 40-60 program selected. To select a different program, you can use the **Touch Control Program Direction Keys** on the panel.

20 12 For the washing program you have selected, the **Digital Display** shows the washing time and max kg for this washing program respectively. When the Max. kg information appears **Program Max. Laundry Load LED Light** lights up.

13 When the Auxiliary Function selection is activated, the selected **Active Auxiliary Function LED Light** illuminates during the wash time. If the auxiliary function cannot be selected in the selected washing program, the Active Auxiliary Function LED Light will blink repeatedly.

14 When the Saving Mode Auxiliary Function selection is activated, the **Save+ Mode Active LED Light** illuminates during the wash time. If the saving mode auxiliary function cannot be selected in the selected washing program, the Save+ Mode Active LED Light will blink repeatedly.

15 When the door of your machine is locked, the **Door Closed LED Light** will stay on active until the washing process is finished.

19 Energy/Water Efficiency Bar:

“” is an efficiency indicator comprising 2 bars. The energy/water efficiency bar shows the amount of energy and water consumption. The bigger the bar is, the more energy or water consumption you will have. The energy/water efficiency bar might extend or shorten depending on the selected program's duration, temperature setting, spin speed and other auxiliary functions.

22 In cases where you can add laundry

to your machine, **Add Laundry LED Light** illuminates. If the Add Laundry LED Light is not on, you cannot add laundry to your machine. If you want to add laundry while the washing is in progress, you can add laundry by putting the machine in Standby mode.

 You can perform drum cleaning for your machine by pressing both touch program direction buttons at the same time for 3 seconds, it can be adjusted in all program positions. It should be used without laundry. You can use a descaler specially developed for washing machines or a washing machine drum cleaning detergent. It is recommended to use once a month.

NOTE: Your washing machine is switched on with the key sound feature activated. You can turn off the **key sound*** of your washing machine by pressing and holding the Speed Adjustment and Auxiliary Rinse Function keys at the same time. You can activate it again with the same key combination.

(*) The appliance specifications may vary depending on the purchased product.

5. USING YOUR WASHING MACHINE

5.1 Preparing Your Laundry

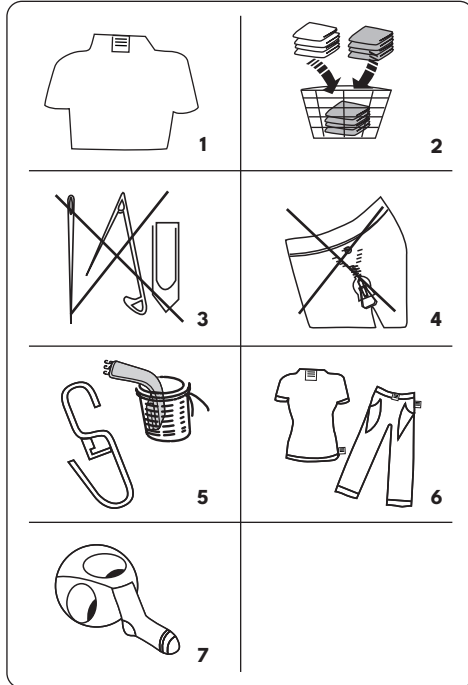











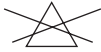

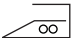
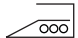
- Follow the instructions given in the care labels on the clothing.
 - Separate your laundry according to type (cotton, synthetic, sensitive, wool etc.), washing temperature (cold, 30°, 40°, 60°, 90°) and the degree of dirtiness (slightly stained, stained, highly stained).
- Never wash coloured and white laundry together.
 - Dark textiles may contain excess dye and should be washed separately.
- Ensure that there are no metallic materials on your laundry or in the pockets; if so, remove them.

CAUTION: Any malfunctions which occur due to foreign materials damaging your machine are not covered by the warranty.

- Close zips and fasten any hooks and

eyes.

- Remove the metallic or plastic hooks off curtains or place them in a washing net or bag.
- Turn garments inside out.
- Wash socks, handkerchiefs and other small items in a washing net.

 Can be bleached	 Do not bleach	 Normal washing
 Maximum ironing temperature 150°C	 Maximum ironing temperature 200°C	 Do not iron
 Can be dry cleaned	 No dry cleaning	 Dry flat
 Drip dry	 Hang to dry	 Do not tumble dry
 Dry cleaning in gas oil, pure alcohol and R113 is allowed	 Perchloroethylene R11, R13, Petroleum	 Perchlorinetylene R11, R113, Gas oil

5.2 Putting Laundry in the Machine

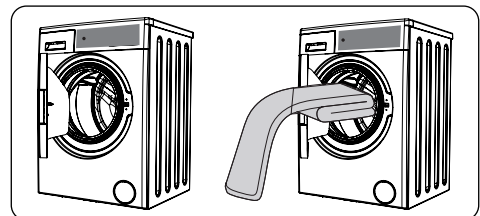

- Open the door of your machine.
- Spread your laundry evenly in the machine.

NOTE: Take care not to exceed the maximum load of the drum as this will

give poor wash results and cause creasing. Refer to the washing programme tables for information on load capacities.

The following table shows approximate weights of typical laundry items:

LAUNDRY TYPE	WEIGHT (gr)
Towel	200
Linen	500
Bathrobe	1200
Quilt cover	700
Pillow slip	200
Underwear	100
Tablecloth	250

- Load each item of laundry separately.
- Check that no items of laundry are trapped between the rubber seal and the door.
- Gently push the door until it clicks shut.

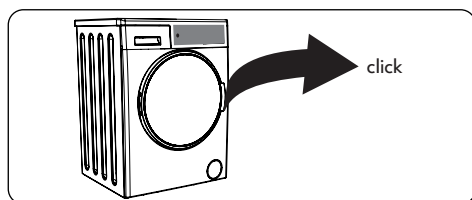

- Make sure the door is fully closed, otherwise the programme will not start.

5.3 Adding Detergent to the Machine

The amount of detergent you will need to put in your machine will depend on the following criteria:

- If your clothes are only slightly soiled, do not pre-wash. Put a small amount of detergent (as specified by the manufacturer) into compartment II of the detergent drawer.
- Using the amounts of detergent recommended by the manufacturer on the packaging prevents excessive foam formation and poor rinsing.
- If your clothes are excessively soiled,

select a programme with pre-wash and put $\frac{1}{4}$ of the detergent to be used into compartment I of the detergent drawer and the rest in compartment II.

- Use detergents produced for automatic washing machines. Follow the manufacturer's instructions on the amount of detergent to use.
- In areas of hard water, more detergent will be required.
- The amount of the detergent required will increase with higher washing loads.
- Put softener in the middle compartment of the detergent drawer. Do not exceed the MAX level.
- Thick softeners may cause clogging of the drawer and should be diluted.
- It is possible to use fluid detergents in all programmes without a pre-wash. To do this, slide the fluid detergent level plate (*) into the guides in compartment II of the detergent drawer. Use the lines on the plate as a guide to fill the drawer to the required level.

(*) Specifications may vary depending on the machine purchased.

5.4 Operating Your Machine

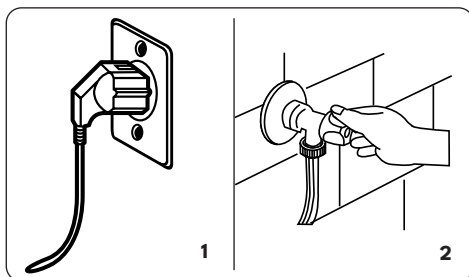

1. Plug your machine in to the mains supply.
2. Turn on the water supply.
 - Open the machine door.
 - Evenly spread your laundry in the machine.

- Gently push the door until it clicks shut.
3. Press the On / Off button.

5.5 Selecting a Programme

Use the programme table to select the most appropriate programme for your laundry.

5.6 Half-Load Detection System

Your machine features a half-load detection system.

If you put less than half the maximum load of laundry into your machine it will automatically set the half-load function, regardless of the programme you selected. This means that the selected programme will take less time to complete and will use less water and energy.

(*)Machinery specifications may vary depending on the product purchased.

5.7 Auxiliary Functions

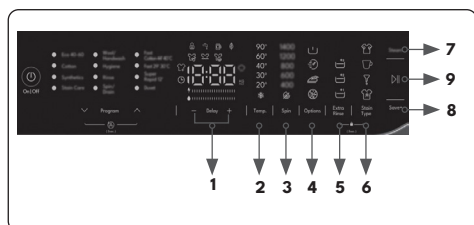

You can select auxiliary functions before starting the washing program.

- Press the key of the auxiliary function you want to select.
 - If the symbol of the auxiliary function is continuously on in the electronic display, the selected auxiliary function will be enabled.
 - If the symbol of the auxiliary function is flashing in the electronic display, the selected auxiliary function will not be enabled.

Reason for not enabling the function:

- That auxiliary function might not be available for the selected washing program.

- The machine might have passed the step where that auxiliary function could be applied.
- The auxiliary function might be incompatible with another auxiliary function you have previously selected.

1. Delayed start auxiliary function

You can use this auxiliary function to delay the start time of the washing cycle for 1 to 23 hours.

To use the delay function:

- Press the + symbol once.
- "01h" will appear on the display. ⌚ symbol will appear on the electronic display.
- You can set the time after which you want your machine to start washing by pressing the + / - symbols.
- To use the time delay function, you need to press the Start/Pause key to activate the machine.
- If you want to cancel the time delay function after you have activated it by turning the machine on with Start/Pause key, press + / - symbols once. ⌚ symbol will disappear on the electronic display.
- If you have not pressed the Start/Pause key, press one of the + / - symbols repeatedly until the ⌚ symbol on the electronic display disappears. ⌚ symbol will disappear on the electronic display.

2. Selecting the washing water temperature

You can use the washing water temperature setting key to set the temperature of the washing water for your laundry.

- When you select a new program, the selected program's maximum washing water temperature will be displayed on the digital display.
- You can press the washing water temperature setting key to decrease the washing water temperature gradually between the maximum

water temperature of the selected program and cold water wash (❄️).

- If you have skipped the washing water temperature you wanted to set, press the washing water temperature key repeatedly to select the desired temperature again.
- You can use this auxiliary function to wash your laundry with cold water (tap water).
- Each time the temperature setting key is pressed on the display panel, the temperature value decreases according to the program feature.

3. Spin speed selection

You can use the speed setting key to set the spin speed for your laundry.

- When you select a new program, the selected program's maximum spin speed will be displayed on the digital display.
- You can press the spin speed setting key to decrease the spin speed gradually between the selected program's maximum spin speed and the spin cancelled (🛑) option.
- If you have skipped the spin speed you wanted to set, you can keep pressing the spin speed key to find the desired speed again.
- You can use this auxiliary function to wash your laundry without spinning.
- Each time the spin speed key is pressed on the display panel, the spin speed value decreases according to the program feature.

4. Options

With the options key, you can select the most suitable auxiliary function for your laundry by pressing the options key on the display panel.

4.1 Prewash auxiliary function

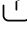
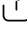

You can use this auxiliary function to

perform pre-wash before the main wash cycle for your highly soiled laundry.

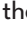
When you use this function, you need to add detergent into the prewash dispenser of the detergent drawer. To enable the prewash auxiliary function, press the options key until the prewash symbol  appears. If the prewash LED  is constantly on in the electronic display, it means that the auxiliary function is selected.

 NOTE: When you want to select the prewash auxiliary function, if  does not appear on the display, this means that this feature is not available in the selected washing program.

4.2 Quick wash auxiliary function

Using this auxiliary function, you can wash your laundry in less time and with less energy and water consumption. (It is recommended to load the machine with half or less than half of the capacity of the selected washing program.) To enable the quick wash auxiliary function, press the options key until the quick wash symbol  appears. If the quick wash LED  is constantly on in the electronic display, it means that the auxiliary function is selected.

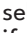
 NOTE: When you want to select the quick wash auxiliary function, if  symbol does not appear on the display, this means that this feature is not available in the selected washing program.



4.3 Easy ironing auxiliary function



This auxiliary function allows you to have less creased clothes after washing. To enable the easy ironing auxiliary function, press the options key until the easy ironing symbol appears. If the easy ironing LED  is constantly on in the electronic display, it means that the auxiliary function is selected.

 NOTE: When you want to select

the easy ironing auxiliary function, if  does not appear on the display, this means that this feature is not available in the selected washing program.



4.4 Anti-Allergy auxiliary function



You can use this auxiliary function to add another rinse cycle for your laundry. Your machine will use hot water in all rinsing steps. (It is recommended for sensitive skin clothing, baby clothes and underclothes). To enable the Anti-Allergy auxiliary function, keep pressing the options key until the Anti-Allergy function symbol  appears. If the Anti-Allergy symbol  is constantly on in the electronic display, it means that the auxiliary function is selected.

 NOTE: When you want to select the Anti-Allergy auxiliary function, if  does not appear on the display, this means that this feature is not available in the selected washing program.

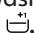
5. Extra rinse function

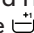
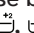
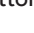
You can use this auxiliary function for extra rinse on your laundry.

- During the selection of the washing program or during the washing process, you can select 1 , 2  and 3  different levels of extra rinse.
- When you press the Extra rinse button on the display panel, the , ,  symbols will appear on the screen consecutively.
- Your selection will be completed when the symbol of the desired level is activated.

 NOTE: When you want to select extra rinse function, if  symbol flashes on the screen, this means that this feature is not available in the selected washing program.

6. Stain selection

You can make use of these auxiliary functions on washing depending on the





types of stains.

Warning: Do not let the stains on your laundries to get dry and stuck in order for the auxiliary function dedicated for soiling level selection to fully perform its functions. Clean the solids beforehand.

Warning: Press on the newly formed stains on your laundries with a piece of cloth before starting washing them in your product. Do not scrub!

Your washing machine adjusts the washing temperature, drum rotation, and number and duration of rinse automatically according to the type of stain.

For example, the stain removal methods of your washing machine are as follows:

	- Sweat Stain
	- Coffee Stain
	- Oil Stain
	- Mixed

Sweat Stain: Your washing machine soaks sweat-stained clothes in cold water before washing to remove the stains. The washing program you have selected will then be activated.

Coffee Stain: Your washing machine will increase the number of washing steps of the selected washing program and use a separate washing algorithm to remove stains.

Oil Stain: Your washing machine will rinse the oil-stained clothes in cold water before washing, then increase the number of washing steps of the program you have selected and use a separate washing algorithm to remove oil stains.

Mixed: Your washing machine will rinse your laundry with mixed stains in hot water before washing, then increase the number of washing steps of the program you have selected and use a separate washing algorithm to remove mixed stains from the laundry.

(*) The appliance specifications may vary depending on the purchased product.

NOTE: Before starting your machine, you can switch between stain types. Once you have started the machine, you cannot cancel or change the selected stain type. You can cancel the washing program of your machine, and select the correct stain type and restart the program. If the desired results could not be achieved with the set stain selection at the end of washing, you may have selected the wrong type; restart the washing cycle with the correct stain selection to remove the stain.

7. Steam auxiliary function

Steam auxiliary function allows you to have less creased clothes after washing.

- Press the **Steam** auxiliary function key once.
- The steam auxiliary function symbol  LED light on your machine's display panel lights up.

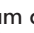
NOTE: When you want to select steam auxiliary function, if  symbol flashes on the screen, this means that this feature is not available in the selected washing program.

 You can perform a refresh process for your laundry by pressing the Steam Assist button for 3 seconds, it can be adjusted in all program positions. Thanks to this refresh process, steam penetrates the laundry and cleans your clothes by removing unwanted odors. It should be used with a maximum of 2 kg of laundry.

8. Save+ mode auxiliary function

If you select this auxiliary function, your machine will slightly extend the duration of the washing program. However, it will perform the washing process with less energy and less water consumption.

To activate the Save+ mode function:

- **Press the Save+ mode** auxiliary function key once.
- The eco washing symbol  will appear on the display panel of your machine.



NOTE: When you want to select the save+ mode auxiliary function, if  does not appear on the display, this means that this feature is not available in the selected washing program.

9. Start/pause key

By pressing the Start/Pause key  you can start the program you have selected and put the ongoing program on hold.

5.8 Child Lock

Your machine is equipped with a child lock to protect the program progress if Extra Rinse Function Key and Options keys are pressed while washing is in progress. The child lock will be activated 3 seconds after pressing both keys 5 and 6 on the electronic display at the same time.

When activated, the  symbol appears on the electronic display. If any key is pressed while the child lock is activated, the  symbol flashes on the electronic display. In order to deactivate, you need to press the same buttons for more than 3 seconds. When the child lock is deactivated, the  symbol on the electronic display disappears.

5.9 If you want to cancel a running program:

- The program is canceled by pressing and holding the On/Off button for 3 seconds.
- Your machine will stop washing process and the program will be cancelled.
- To discharge the water in the machine, select any program.
- Your machine will drain the water and cancel the program.
- You can select a new program and start the machine.

5.10 Program End

Your machine will automatically stop when the selected program ends.

- “End” will appear on the electronic display.
- You can open the door of the machine and take out the laundry. After taking out the laundry, leave the door open so that the inside of the machine can dry.
- Unplug the machine.
- Turn off the water tap.

On / Off Button

With this button you can turn your machine on and off.

6. PROGRAM TABLE

Program	Washing Temperature (°C)	Maximum Dry Laundry Amount (kg)	Detergent Dispenser	Program Duration (min.)	Laundry Type / Remarks
Eco 40-60	*40 - 60	10,5	2	240	Dirty cotton and linen textiles. (Underwear, bed sheet, table clothes, (towels, max. 5,0 kg), bedclothes, etc.)
Cottons	*60 - 40 - 30 - "- -C" - 90	10,5	2	110	Dirty, light colors, whites, cotton and linen textiles (underwear, sheets, tablecloths, towels (maximum 5,0 kg), duvet covers, etc.)
Synthetics	*40 - 30 - "- -C"	4	2	135	Normally soiled synthetic or synthetic blended textiles. (Nylon socks, shirts, blouses, synthetic trousers, etc.)
Stain Care	*60" - 40 - 30 - "- -C"	4	1&2	122	Very dirty cotton and flax textiles. (Underwear, linen, tablecloth, towel, bedclothes etc.)
Wool / Hand Wash	*30 - "- -C"	2	2	54	Woolen textiles having machine washable label.
Hygiene	*30 - "- -C" - 60 - 40	5	2	78	Baby laundry (With the 30°C temperature selection, you can ensure hygiene on your laundry. With the 60°C temperature selection, you can provide a more intensive wash and hygiene)
Rinse / Spin	** - -C"	10,5	-	24	If you want to get an additional rinse after washing your laundry, you can use this program for all kinds of laundry. You can use the spinning program when you want to perform an additional spinning process after washing. To activate the spin program, the additional rinse function selected in this program must be cancelled.
20°C	*20 - "- -C"	5	2	59	Less dirty, cotton and linen textiles. (Underwear, bedsheet, tablecloth, etc.)
Fast Cottons 44' 40°C	*40 - 30 - "- -C" - 60	10,5	2	44	The quick wash program cleans your lightly soiled or unspotted colored laundry in just 44 minutes at selectable temperatures up to 40°C. Flexible temperature options provide cleaning suitable for various fabric types, while the machine's ability to wash laundry up to its full capacity allows you to easily clean large amounts of laundry.
Fast 29' 30°C	*30 - "- -C"	5	2	29	The quick washing program helps you save time by cleaning your lightly soiled or unspotted black and/ or dark colored laundry in just 29 minutes at selectable temperatures up to 30°C. You can quickly wash your lightly soiled or unspotted black or dark colored laundry at half the capacity of the machine and complete your daily cleaning routine in a practical way.
(**) Super Fast 12'	*30 - "- -C"	2	2	12	The quick washing program allows you to save time by cleaning your lightly soiled or unspotted black or dark colored laundry in a very short time, such as 12 minutes, at selectable temperatures up to 30°C. With this program, you can quickly wash up to a maximum of 2 kg of laundry. This program provides great convenience, especially in emergency situations or when quick cleaning is required.
Duvet	*40 - 30 - "- -C"	-	2	87	You can wash your fiber duvets that bear machine washable label (max. 3 kg)

NOTE: PROGRAM DURATION MAY VARY DEPENDING ON THE AMOUNT OF LAUNDRY, TAP WATER, AMBIENT TEMPERATURE AND SELECTED AUXILIARY FUNCTIONS.

(*) **Washing water temperature of the program is the factory default.**

(**) **NOTE: As the washing period is short, the amount of the detergent should be much less with respect to the other washing programs. If the machine detects an unbalanced load, the program duration will increase. You can open your washing machine's door 2 minutes after the washing cycle ends.**

The Eco 40-60 program can clean normally soiled cotton laundry that can be washed at 40-60° in the same cycle. This program is designed in line with EU eco-design legislation.

NOTE: If options are changed after the program is selected, temperature and speed values may change. It is recommended to check before starting the machine.

NOTE: To have your machine drain, you need to set the program selection to Rinse/Spin position, and cancel the additional rinse function and spin speed selection. You can use the drain program in cases where the water accumulated inside your machine needs to be drained (adding laundry, removing laundry, etc.).

- The most energy efficient programmes are generally those that run at a lower temperature and for a longer duration.
- Only running the washing machine when it's loaded to the full capacity as indicated by the manufacturer will help to save both water and energy.
- Program duration, energy consumption and water consumption values may vary according to wash load weight and type, selected extra functions, water hardness and ambient temperature. According to the EU Ecodesign regulation the values given for programs other than the ECO 40-60 are indicative only.
- It's recommended to use liquid detergent for the washing programmes at low temperature. The amount of detergent to be used may vary depending on the amount of laundry and the level of dirtiness of the laundry. Please follow the detergent manufacturers' recommendations for the amount of the detergent to be used.
- The noise and remaining moisture content are influenced by the spinning speed. The higher spinning speed in the spinning phase, the higher noise and the lower remaining moisture content.
- You can access the product database where the model information is stored by reading the QR code on the energy label.

Programme Name	Rated Capacity kg	Energy Consumption kWh/cycle			Programme Duration Hours:Minutes			Water Consumption Litres/Cycle			max. Temperature °C			Remaining Moisture Content % 1400 Rpm		
		Rated Capacity	1/2 Load	1/4 Load	Rated Capacity	1/2 Load	1/4 Load	Rated Capacity	1/2 Load	1/4 Load	Rated Capacity	1/2 Load	1/4 Load	Rated Capacity	1/2 Load	1/4 Load
Cotton 90	10,5	2,290			02:53			99,0			81			53%		
Cotton 60	10,5	1,010			01:50			47,0			60			53%		
Eco 40-60	10,5	0,806	0,279	0,149	04:00	03:00	03:00	64,9	38,9	23,4	39	25	23	53%	53%	53%
Synthetics	4	1,180			02:15			84,0			45			53%		
Fast Cottons 44'	10,5	0,450			00:44			40,0			40			62%		
20°C	5	0,080			00:59			32,0			20			53%		

6.1 Important Information

- Use detergents, softeners and other additives suitable for automatic washing machines only. Using too much detergent can cause excessive foam to occur. If foam occur, the foam absorption system activated.
- We recommend that you fully clean the washing machine every two months. For periodic cleaning please use Drum Clean programme. If your machine does not have a Drum Clean programme, please use the Cottons-90 programme. When required, use limescale removers manufactured specifically for washing machines only.
- Never force the door open when your Washing Machine is running. You can open the door of your machine 2 minutes after the completion of a of a wash cycle. *
- Never force the door open when your Washing Machine is running. The door will open immediately after the washing cycle has ended. *
- The installation and repairing procedures should always carried out by the Authorised Service Agent in order to avoid possible risks. The manufacturer shall not be held liable for damages that may arise from procedures carried out by unauthorised persons.

(*) Specifications may vary depending on the machine purchased.

7. CLEANING AND MAINTENANCE

7.1 Warning

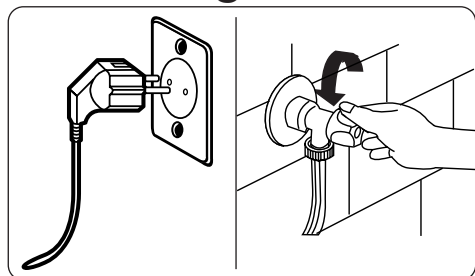

Turn your mains power supply off and remove the plug from the socket before carrying out maintenance and cleaning of your machine.

Turn off the water supply before starting maintenance and cleaning of your machine.

⚠ CAUTION: Do not use solvents, abrasive cleaners, glass cleaners or all-purpose cleaning agents to clean your Washing Machine. They may damage the plastic surfaces and other

components with the chemicals they contain.

7.2 Water Inlet Filters

Water inlet filters prevent dirt and foreign materials from entering your machine. We recommend that these filters are cleaned when your machine is unable to receive sufficient water, although your water supply is on and the tap is open. We recommend that you clean your water inlet filters every 2 months.

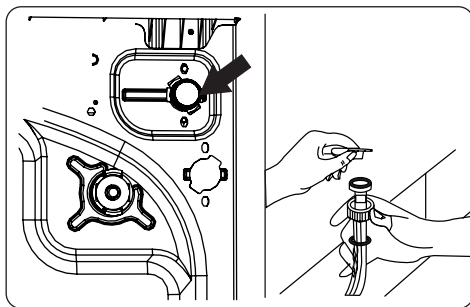

- Unscrew the water inlet hose(s) from the Washing Machine.
- To remove the water inlet filter from the water inlet valve, use a pair of long-nosed pliers to gently pull on the plastic bar in the filter.
- A second water inlet filter is located in the tap end of the water inlet hose. To remove the second water inlet filter, use a pair of long-nosed pliers to gently pull on the plastic bar in the filter.
- Clean the filter thoroughly with a soft brush and wash with soapy water and rinse thoroughly. Re-insert the filter by gently pushing it back into place.

⚠ CAUTION: The filters at the water inlet valve may become clogged due to water quality or lack of required maintenance and may break down. This may cause a water leak. Any such breakdowns are out of the scope of the warranty.

7.3 Pump Filter

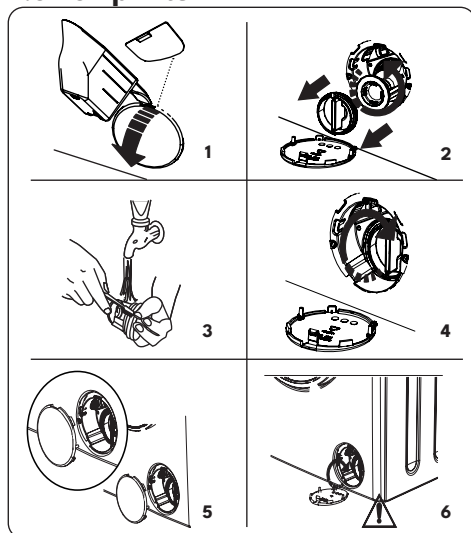

The pump filter system in your Washing Machine prolongs the life of the pump by preventing lint from entering your machine.

We recommend that you clean the pump filter every 2 months.

The pump filter is located behind the cover on the front-lower right corner.

To clean the pump filter:

1. You may use the washing powder spade (*) supplied with your machine or liquid detergent level plate to open the pump cover.
2. Lodge the end of the powder spade or liquid detergent level plate in the opening of the cover and gently press backwards. The cover will open.
- Before opening the filter cover, place a container under the filter cover to collect any water left in the machine.
- Loosen the filter by turning anticlockwise and remove by pulling. Wait for the water to drain.

NOTE: Depending on the amount of water inside the machine, you may have to empty the water collection container a few times.

3. Remove any foreign materials from

the filter with a soft brush.

4. After cleaning, re-fit the filter by inserting it and turning clockwise.
5. When closing the pump cover, ensure that the mountings inside the cover meet the holes on the front panel side.
6. Close the filter cover.

WARNING: The water in the pump may be hot, wait until it has cooled down before carrying out any cleaning or maintenance.

(*) Specifications may vary depending on the machine purchased.

7.4 Detergent Drawer

The use of detergent may cause residual build up in the detergent drawer over time. We recommend that you remove the drawer every 2 months to clean the accumulated residue.

To remove the detergent drawer:

- Pull the drawer forwards until it is fully extended.

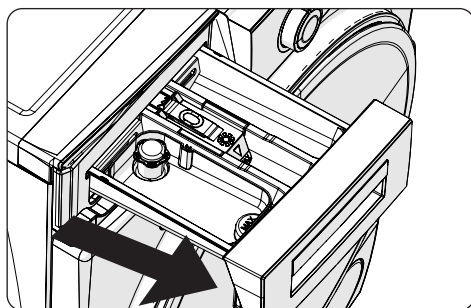

- Press the region shown below inside the detergent drawer you have pulled all the way back, and continue pulling and remove the detergent drawer from its place

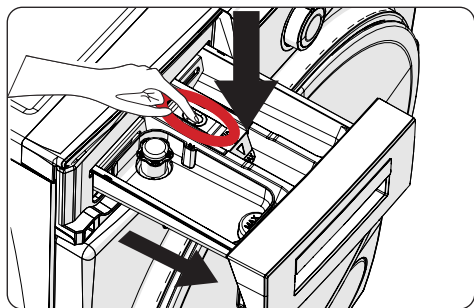

- Remove the detergent drawer and disassemble the flush stopper. Clean thoroughly to completely remove any softener residue. Refit the flush stopper after cleaning and check that it is seated properly.

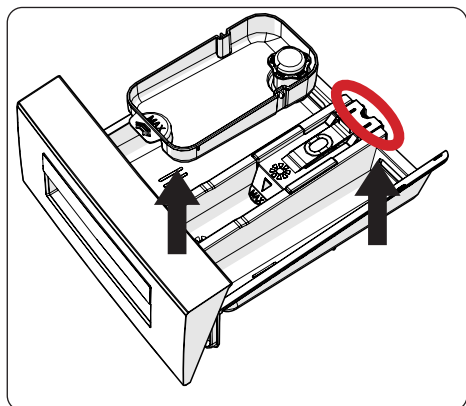

- Rinse with a brush and lots of water.
- Collect the residues inside the detergent drawer slot so that they don't fall inside your machine.
- Dry the detergent drawer with a towel or dry cloth and place it back

! Do not wash your detergent drawer in a dishwasher.

Liquid detergent apparatus(*)

For the cleaning and maintenance of the liquid level detergent apparatus, remove the apparatus from its location as shown in the picture below, and thoroughly clean the remaining detergent residues. Replace the apparatus. Make sure that no residual material remains inside the siphon.

(*) Specifications may vary depending on the machine purchased.

8. Body / Drum

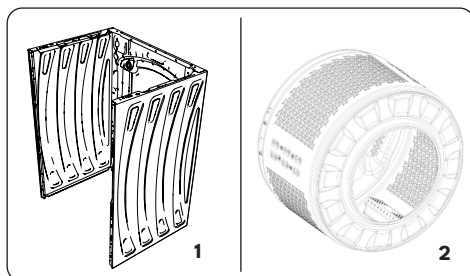

1. Body

Use a mild, non-abrasive cleaning agent, or soap and water, to clean the external casing. Wipe dry with a soft cloth.

2. Drum

Do not leave metallic objects such as needles, paper clips, coins etc. in your machine. These objects lead to the formation of rust stains in the drum. To clean such rust stains, use a non-chlorine cleaning agent and follow the instructions of manufacturer of the cleaning agent. Never use wire wool or similar hard objects for cleaning rust stains.

9. TROUBLESHOOTING

Repair of your machine should be carried out by an authorised service company. If your machine requires repair or if you cannot solve an issue with the information provided below, then you should:

- Unplug your machine from the mains power supply.
- Turn off the water supply.

FAULT	POSSIBLE CAUSE	TROUBLESHOOTING
Your machine does not start.	Machine not plugged in.	Plug machine in.
	Fuses are faulty.	Replace the fuses.
	No mains power supply.	Check mains power.
	Start/Pause button not pressed.	Press the Start/Pause button.
	Programme dial 'stop' position.	Turn the programme dial to the desired position.
	The machine door is not completely closed.	Close the machine door.
Your machine does not intake water.	Water tap is turned off.	Turn tap on.
	Water inlet hose may be twisted.	Check water inlet hose and untwist.
	Water inlet hose clogged.	Clean water inlet hose filters. (*)
	Inlet filter clogged.	Clean the inlet filters. (*)
	The machine door is not completely closed.	Close the machine door.
Your machine does not discharge water.	Drain hose clogged or twisted.	Check the drain hose, then either clean or untwist.
	Pump filter clogged.	Clean the pump filter. (*)
	Laundry is too tightly packed together in the drum.	Spread your laundry in the machine evenly.
Your machine vibrates.	The feet have not been adjusted.	Adjust the feet. (**)
	Transit bolts fitted for transportation have not been removed.	Remove the transit bolts from the machine. (**)
	Small load in the drum.	This will not prevent operation of your machine.
	Your machine is overloaded with laundry or laundry is unevenly spread.	Do not overload the drum. Spread laundry evenly in the drum.
Excessive foam is formed in the detergent drawer.	Excessive amount of detergent used.	Press the Start/Pause button. To stop the foam, dilute one tablespoon of softener into 1/2 litre of water and pour into the detergent drawer. Press the Start/Pause button after 5-10 mins.
	Wrong detergent used.	Only use detergents produced for automatic Washing Machines.

FAULT	POSSIBLE CAUSE	TROUBLESHOOTING
Unsatisfactory washing result.	Your washing is too dirty for the programme selected.	Use the information in the programme tables to select the most appropriate programme.
	Amount of detergent used insufficient.	Use the amount of detergent as instructed on the packaging.
	There is too much laundry in your machine.	Check that the maximum capacity for the selected programme has not been exceeded.
Unsatisfactory washing result.	Hard water.	Increase the amount of detergent following the manufacturer's instructions.
	Your laundry is too tightly packed together in the drum.	Check that your laundry is spread out.
As soon as the machine is loaded with water, water discharges.	The end of water drain hose is too low for the machine.	Check that the drain hose is at a suitable height. (**).
No water appears in the drum during washing.	No fault. Water is in the unseen part of the drum.
Laundry has detergent residue.	Non-dissolving particles of some detergents may appear on your laundry as white spots.	Perform an extra rinse, or clean your laundry with a brush after it dries.
Grey spots appear on the laundry.	There is untreated oil, cream or ointment on your laundry.	Use the amount of detergent as instructed on the packaging in the next wash.
The spin cycle does not take place or takes place later than expected.	No fault. The Unbalanced load control system has been activated.	The Unbalanced load control system will try to spread your laundry. The spinning cycle will begin once your laundry is spread. Load the drum evenly for the next wash.

(*) See the chapter regarding maintenance and cleaning of your machine.

(**) See the chapter regarding installation of your machine.

10. AUTOMATIC FAULT WARNINGS AND WHAT TO DO

Your Washing Machine is equipped with a built-in fault detection system, indicated by a combination of flashing wash operation lights. The most common failure codes are shown below.

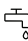
TROUBLE CODE	POSSIBLE FAULT	WHAT TO DO
E01	The door of your machine is not shut properly.	Shut the door properly until you hear a click. If your machine persists to indicate fault, turn off your machine, unplug it and contact the nearest authorised service agent immediately.
E02 	The water pressure or the water level inside the machine may be low.	Check the tap is fully turned on. Mains water may be cut-off. If the problem still continues, your machine will stop after a while automatically. Unplug the machine, turn off your tap and contact the nearest authorised service agent.
E03	The pump is faulty or pump filter is clogged or electrical connection of the pump is faulty.	Clean the pump filter. If the problem persists, contact the nearest authorised service agent. (*)
E04	Your machine has excessive amount of water.	Your machine will discharge water by itself. Once the water has drained, turn off your machine and unplug it. Turn off the tap and contact the nearest authorised service agent.

(*) See the chapter regarding maintenance and cleaning of your machine.



NO

Service: Kontakt butikken der du kjøpte produktet så de kan henvise deg til lokal service

Oppgi: Produkttype, Serienummer, Kjøpsdato, Problembeskrivelse, Navn og adresse, Telefonnummer

DK

Service: Kontakt butikken hvor købet blev foretaget og få info om service kontakt

Nødvendig information: Model navn, Serienummer (står på typeskiltet), Kjøpsdato, Beskrivelse af problemet, Navn og adresse, Telefonnummer

FI

Huolto: Ota yhteyttä myymälään, josta ostit tuotteen, niin saat lisätietoja lähimmästä huoltoliikkeestä

Tarvittavat tiedot: Mallinnumero, Sarjanumero, Ostopäivä, Ongelman kuvaus, Nimi ja osoite, Puhelinnumero

SE

Service: Vi har service i hela Sverige. Besök www.cylinda.se
Ring 0771-25 25 00
(endast lokaltaxa)

Uppge: Maskintyp, serienummer, inköpsdatum, problembeskrivning, namn och adress, ditt telefonnummer

Kontakta oss:
www.cylinda.se

UK

Service: Nationwide service in Sweden
Visit www.cylinda.se
Call 0771-25 25 00

Declare: Model code, Serial number, Purchase date, Problem description, Name and address, Phone number

Contact us:
www.cylinda.se

Cylinda
en enklare vardag

Cylinda AB, Haukadalsgatan 8A, 164 40 Kista

52587523